

Meeting Rooms
Lake Hart A

Classroom Set Up
Capacities

| | |
|-----------|--------|
| Length | 31'-0" |
| Width | 23'-6" |
| Height | 13'-0" |
| Area (SF) | 728 |
| CR2 | 30 |

Notes:

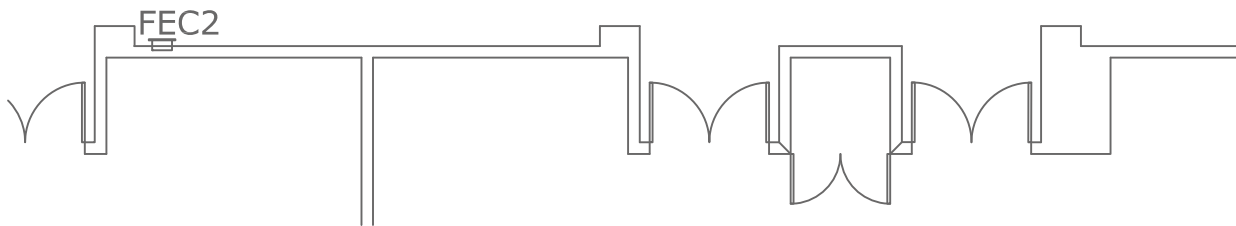
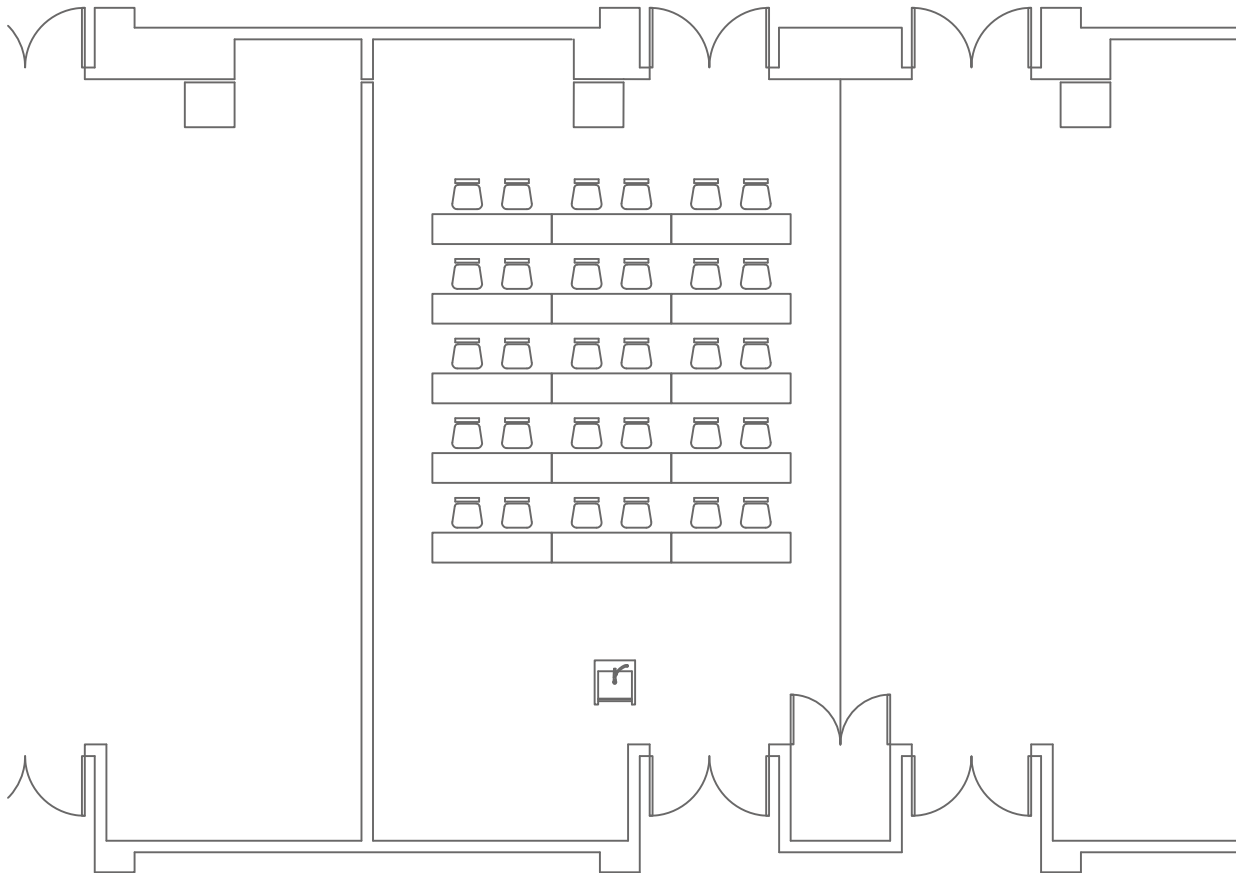
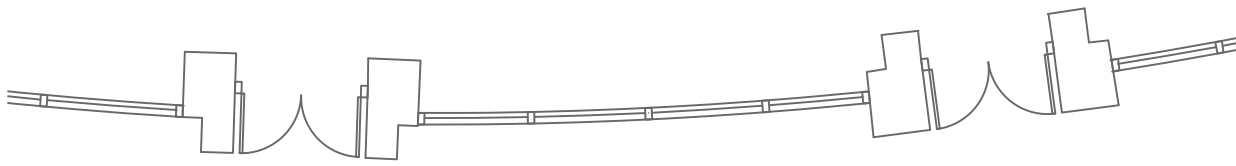

FREEMAN

- Conventions
- Corporate Events
- Exhibits